



BANYAN TREE
KRABI

Dragon Crest Mountain
(The National Park)



HOTEL
ENTRANCE

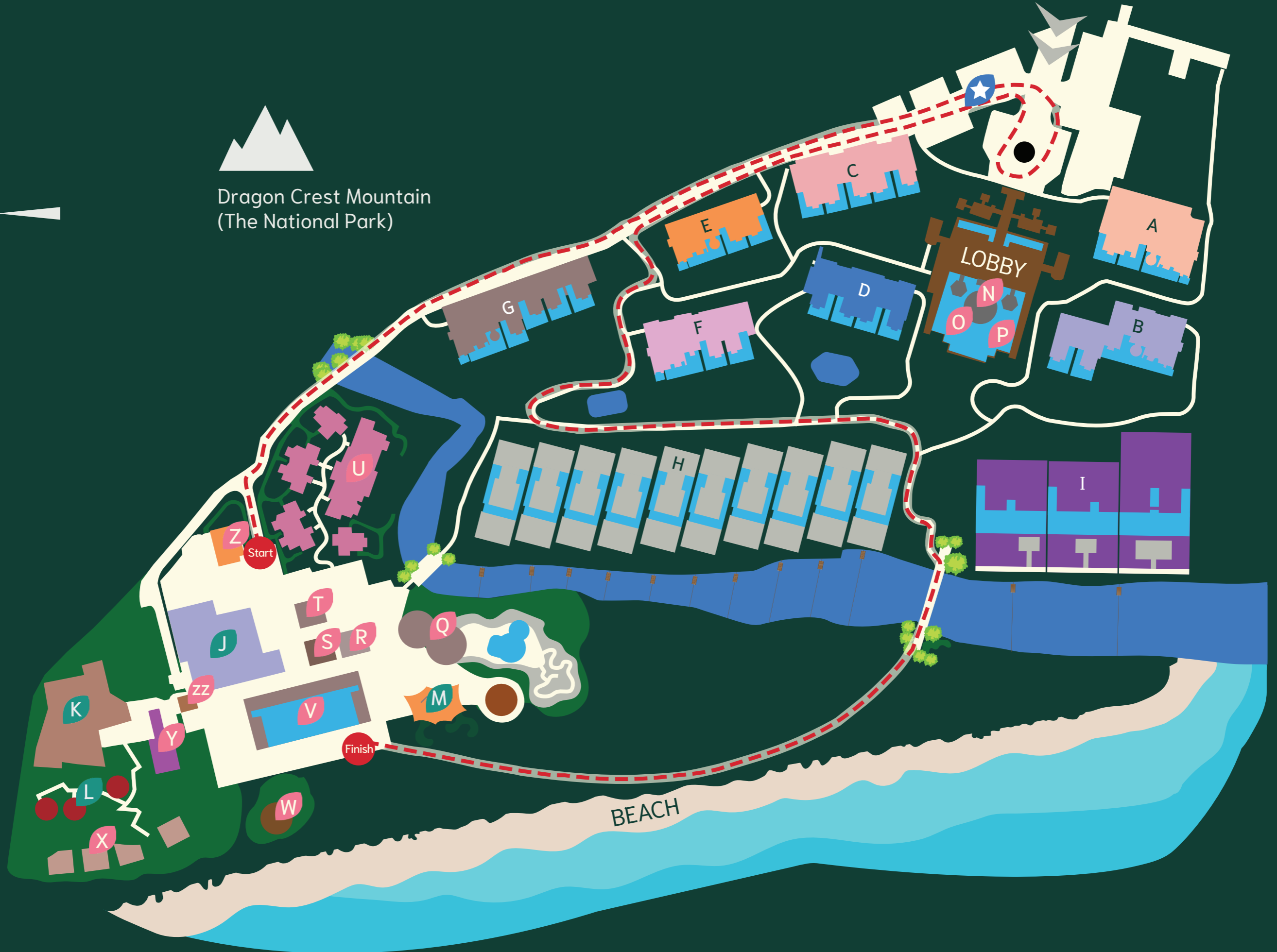

BANYAN TREE KRABI MAP LEGEND

SUITES

- | | |
|---|---|
| <p>Block A Partial Ocean Pool Suite, Premium Ocean Pool Suite, and Two Bedroom Ocean Pool Suite</p> <p>Block B Deluxe Garden Pool Suite, Premium Ocean Pool Suite, and Two Bedroom Ocean Pool Suite</p> <p>Block C D Partial Ocean Pool Suite, Premium Ocean Pool Suite and Wellbeing Sanctuary Pool Suite</p> | <p>Block E Partial Ocean Pool Suite, Premium Ocean Pool Suite, Wellbeing Sanctuary Pool Suite, and Two Bedroom Ocean Pool Suite</p> <p>Block F Premium Ocean Pool Suite, Wellbeing Sanctuary Pool Suite, and Two Bedroom Ocean Pool Suite</p> <p>Block G Deluxe Garden Pool Suite, Partial Ocean Pool Suite and Two Bedroom Ocean Pool Suite</p> |
|---|---|

VILLAS

- H** Deluxe Garden Pool Villa and Beachfront Pool Villa
- I** Two Bedroom Beachfront Pool Villa and Presidential Beachfront Pool Villa

DINING FACILITIES

- | | |
|---|--|
| <p>J The Naga Kitchen (All-Day Dining)</p> <p>K Saffron</p> | <p>L Bird's Nest</p> <p>M Kredkaew Bar</p> |
|---|--|

FACILITIES

- | | |
|---|---|
| <p>N Lobby</p> <p>O Muang Moraghod Ballroom</p> <p>P Cave Moraghod Meeting Rooms</p> <p>Q The Kids' Club</p> <p>R Banyan Tree Spa Reception</p> <p>S Banyan Tree Gallery</p> <p>T Mek Khram (Foot Massage and Manicure & Pedicure)</p> | <p>U Banyan Tree Spa and The Rainforest</p> <p>V Main Swimming Pool</p> <p>W Water Sports Counter</p> <p>X Cabana</p> <p>Y Sunset Wedding Deck</p> <p>Z Fitness Centre</p> <p>zz Funicular</p> |
|---|---|

 Assembly Point

 Jogging Track Route (2 Kms)